



**Installation:** Safe Area  
**Insulation Class:** I



**LIGHTING FIXTURE**

|                                 | CEI / EN                                       |
|---------------------------------|--|
| EXECUTION                       | INDUSTRIAL WEATHERPROOF                        |
| RULES OF COMPLIANCE             | EN 60598-1 + A1; EN 60598-2-1;<br>EN 60598-2-3 |
| EC Type-Examination Certificate | -  |
| PROTECTION DEGREE               | IP66   |
| AMBIENT TEMPERATURE             | -  |

**Mechanical characteristics**

|             |  |
|-------------|--|
| Body        | die-cast aluminum  |
| Diffuser    | tempered glass 4mm thickness   |
| Anchorage   | cured poles Ø45-60mm (Ø40 with adapter)  |
| Reflector   | CUT-OFF optic - anodized and polished<br>99,85 pure aluminum   |
| Painting    | thermosetting polyester powder resistant to<br>atmospheric agents and corrosion grey RAL<br>7038/7039 colour |
| Screws      | stainless steel  |
| Gaskets     | silicon rubber gasket running around the body  |
| Cable entry | from pole  |

**Electrical characteristics**

|                 |   |
|-----------------|---|
| Power supply    | conventional ballast 230V - 50Hz<br>(P.F. CORRECTED - $\cos \rho \geq 0,95$ ) |
| Lampholders     | porcelain E27 - E40 size  |
| Internal wiring | high-temperature resistant silicon rubber<br>insulation cables                |
| Terminals       | suitable up to 4sq/mm cables  |



**On Request Accessories:**

- Electronic ballast with voltage supply different than standard
- Insulation class II
- Angle/wall installation bracket
- Pole adapter - dia. 40 mm

## Technical data

| CODE   | LAMP TYPE | TEMPERATURE CLASS (GAS) | TEMPERATURE CLASS (DUSTS) | LAMPHOLDER SIZE | DETAIL |
|--|-----------|-------------------------|---------------------------|-----------------|--------|
| <b>LIGHTING FIXTURE FOR HIGH PRESSURE MERCURY VAPOUR LAMP - POWER SUPPLY 230V 50Hz</b> |           |                         |                           |                 |        |
| M400-125HG   | 125 W     | -                       | -                         | E-27            | A      |
| M400-250HG   | 250 W     | -                       | -                         | E-40            | A      |
| M400-400HG   | 400 W     | -                       | -                         | E-40            | A      |
| <b>LIGHTING FIXTURE FOR METAL HALIDE LAMP - POWER SUPPLY 230V 50Hz</b>                 |           |                         |                           |                 |        |
| M400-70MH  | 70 W      | -                       | -                         | E-27            | A      |
| M400-100MH   | 100 W     | -                       | -                         | E-27            | A      |
| M400-150MH   | 150 W     | -                       | -                         | E-27            | A      |
| M400-250MH   | 250 W     | -                       | -                         | E-40            | A      |
| M400-400MH   | 400 W     | -                       | -                         | E-40            | A      |
| <b>LIGHTING FIXTURE FOR HIGH PRESSURE SODIUM LAMP - POWER SUPPLY 230V 50Hz</b>         |           |                         |                           |                 |        |
| M400-70HPNA  | 70 W      | -                       | -                         | E-27            | A      |
| M400-100HPNA   | 100 W     | -                       | -                         | E-40            | A      |
| M400-150HPNA   | 150 W     | -                       | -                         | E-40            | A      |
| M400-250HPNA   | 250 W     | -                       | -                         | E-40            | A      |
| M400-400HPNA   | 400 W     | -                       | -                         | E-40            | A      |

## M400 Technical features

| CODE         | A [mm] | B [mm] | C [mm] | D [mm] | WEIGHT [Kg] | DETAIL |
|--------------|--------|--------|--------|--------|-------------|--------|
| M400-125HG   | 719    | 228    | 387    | 224    | 10,2        | A      |
| M400-250HG   | 719    | 228    | 387    | 224    | 11,5        | A      |
| M400-400HG   | 719    | 228    | 387    | 224    | 12,9        | A      |
| M400-70MH    | 719    | 228    | 387    | 224    | 10,4        | A      |
| M400-100MH   | 719    | 228    | 387    | 224    | 10,4        | A      |
| M400-150MH   | 719    | 228    | 387    | 224    | 11,7        | A      |
| M400-250MH   | 719    | 228    | 387    | 224    | 11,7        | A      |
| M400-400MH   | 719    | 228    | 387    | 224    | 13          | A      |
| M400-70HPNA  | 719    | 228    | 387    | 224    | 10,5        | A      |
| M400-100HPNA | 719    | 228    | 387    | 224    | 10,5        | A      |
| M400-150HPNA | 719    | 228    | 387    | 224    | 11,7        | A      |
| M400-250HPNA | 719    | 228    | 387    | 224    | 13          | A      |
| M400-400HPNA | 719    | 228    | 387    | 224    | 14,3        | A      |



Reference details

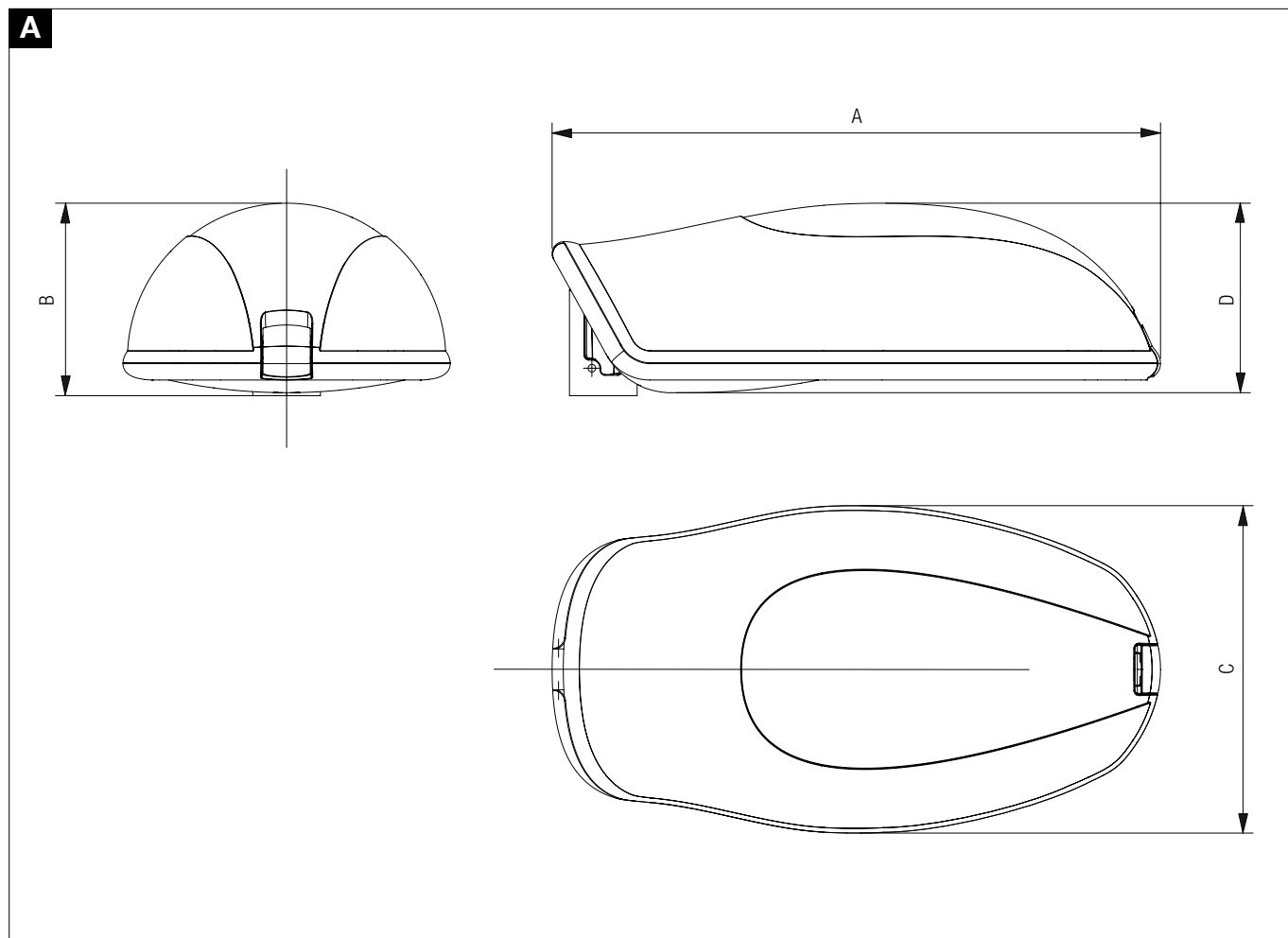

M400 Polar diagrams - photometric data

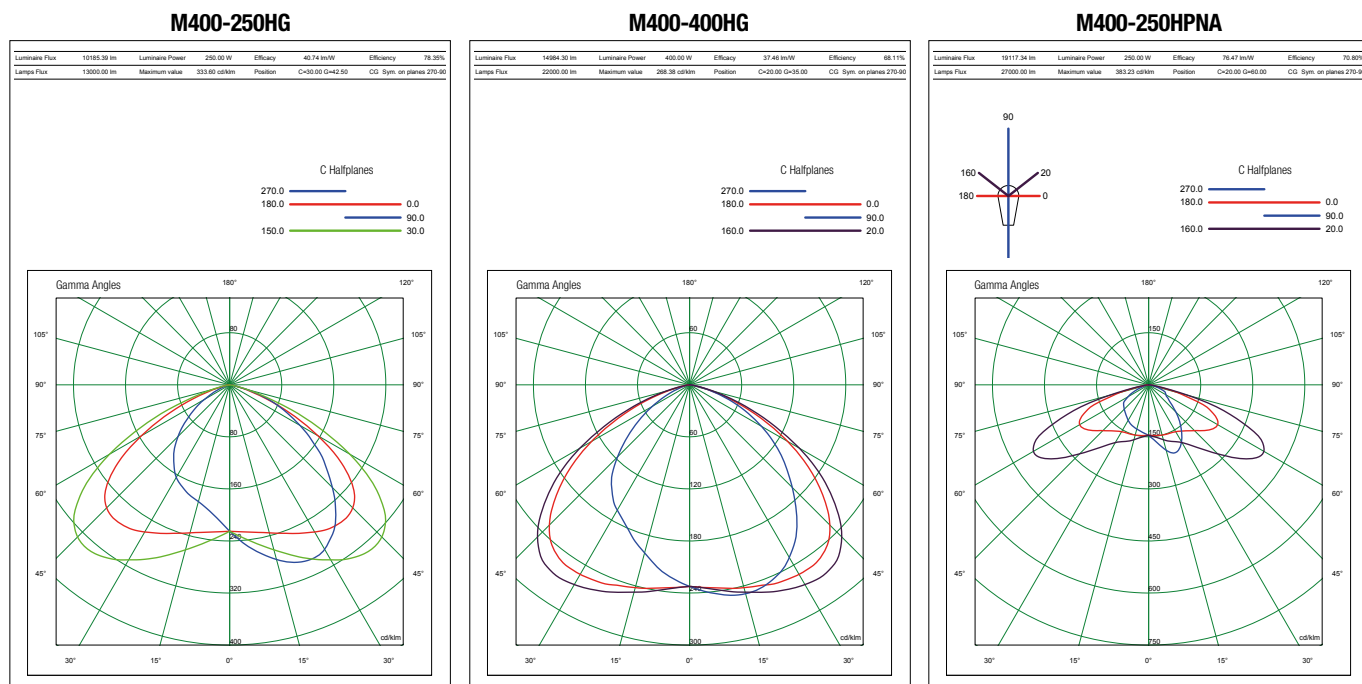

**M400-400HPNA**

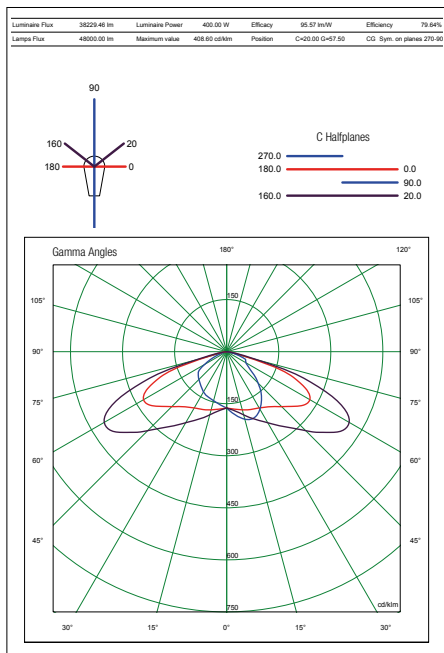

**M400-250MH**

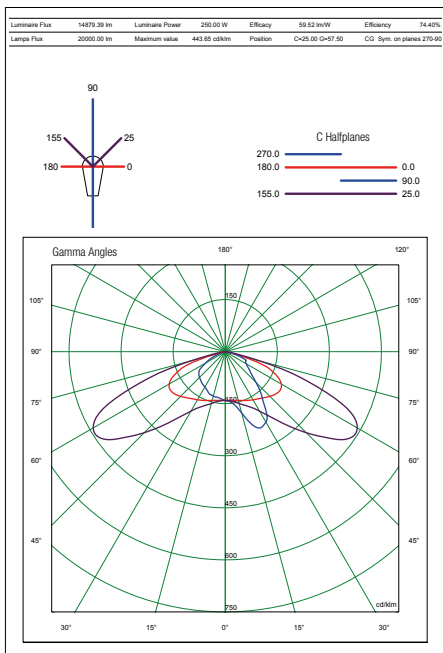

**M400-400MH**

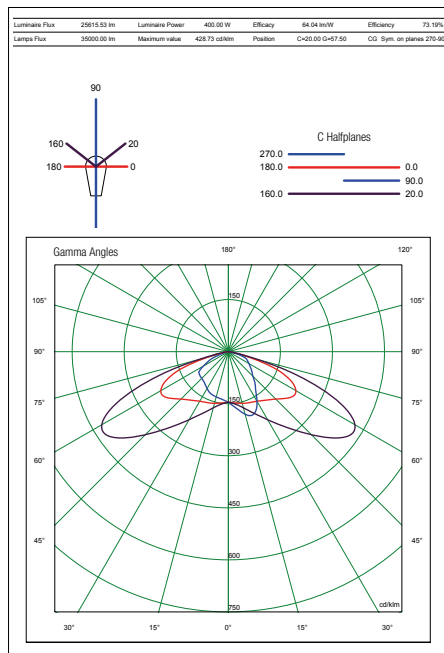

**On request accessories**

| CODE       | DESCRIPTION                     | MATERIAL      |
|------------|---------------------------------|---------------|
| 20303.0120 | ANGLE/WALL INSTALLATION BRACKET | PAINTED STEEL |
| 20303.0121 | POLE ADAPTER - DIA. 40÷60MM     | ALUMINIUM     |
| 20303.0125 | POLE ADAPTER - DIA. 76 MM       | PAINTED STEEL |

**Angle/wall installation bracket**

**20303.0120**



**Pole adapter - dia. 40 mm**

**20303.0121**



**Pole adapter - dia. 76 mm**

**20303.0125**



**REMARK:**

Due to the development of the national and international specifications and of the technology, the above technical characteristics showed on this bulletin can be considered as binding on our confirmation only.

