



**Installation:** Safe Area  
**Insulation Class:** I



**LIGHTING FIXTURE**

	CEI / EN
EXECUTION	INDUSTRIAL WEATHERPROOF
RULES OF COMPLIANCE	EN 60598-1 + A1; EN 60598-2-1; EN 60598-2-3
EC Type-Examination Certificate	-
PROTECTION DEGREE	IP66
AMBIENT TEMPERATURE	-

**Mechanical characteristics**

Body	die-cast aluminum
Diffuser	tempered glass 4mm thickness
Anchorage	cured poles Ø45-60mm (Ø40 with adapter)
Reflector	CUT-OFF optic - anodized and polished 99,85 pure aluminum
Painting	thermosetting polyester powder resistant to atmospheric agents and corrosion grey RAL 7038/7039 colour
Screws	stainless steel
Gaskets	silicon rubber gasket running around the body
Cable entry	from pole

**Electrical characteristics**

Power supply	conventional ballast 230V - 50Hz (P.F. CORRECTED - $\cos \rho \geq 0,95$ )
Lampholders	porcelain E27 - E40 size
Internal wiring	high-temperature resistant silicon rubber insulation cables
Terminals	suitable up to 4sq/mm cables



**On Request Accessories:**

- Electronic ballast with voltage supply different than standard
- Insulation class II
- Angle/wall installation bracket
- Pole adapter - dia. 40 mm

## Technical data

CODE	LAMP TYPE	TEMPERATURE CLASS (GAS)	TEMPERATURE CLASS (DUSTS)	LAMPHOLDER SIZE	DETAIL
<b>LIGHTING FIXTURE FOR HIGH PRESSURE MERCURY VAPOUR LAMP - POWER SUPPLY 230V 50Hz</b>					
M400-125HG	125 W	-	-	E-27	A
M400-250HG	250 W	-	-	E-40	A
M400-400HG	400 W	-	-	E-40	A
<b>LIGHTING FIXTURE FOR METAL HALIDE LAMP - POWER SUPPLY 230V 50Hz</b>					
M400-70MH	70 W	-	-	E-27	A
M400-100MH	100 W	-	-	E-27	A
M400-150MH	150 W	-	-	E-27	A
M400-250MH	250 W	-	-	E-40	A
M400-400MH	400 W	-	-	E-40	A
<b>LIGHTING FIXTURE FOR HIGH PRESSURE SODIUM LAMP - POWER SUPPLY 230V 50Hz</b>					
M400-70HPNA	70 W	-	-	E-27	A
M400-100HPNA	100 W	-	-	E-40	A
M400-150HPNA	150 W	-	-	E-40	A
M400-250HPNA	250 W	-	-	E-40	A
M400-400HPNA	400 W	-	-	E-40	A

## M400 Technical features

CODE	A [mm]	B [mm]	C [mm]	D [mm]	WEIGHT [Kg]	DETAIL
M400-125HG	719	228	387	224	10,2	A
M400-250HG	719	228	387	224	11,5	A
M400-400HG	719	228	387	224	12,9	A
M400-70MH	719	228	387	224	10,4	A
M400-100MH	719	228	387	224	10,4	A
M400-150MH	719	228	387	224	11,7	A
M400-250MH	719	228	387	224	11,7	A
M400-400MH	719	228	387	224	13	A
M400-70HPNA	719	228	387	224	10,5	A
M400-100HPNA	719	228	387	224	10,5	A
M400-150HPNA	719	228	387	224	11,7	A
M400-250HPNA	719	228	387	224	13	A
M400-400HPNA	719	228	387	224	14,3	A

## Reference details

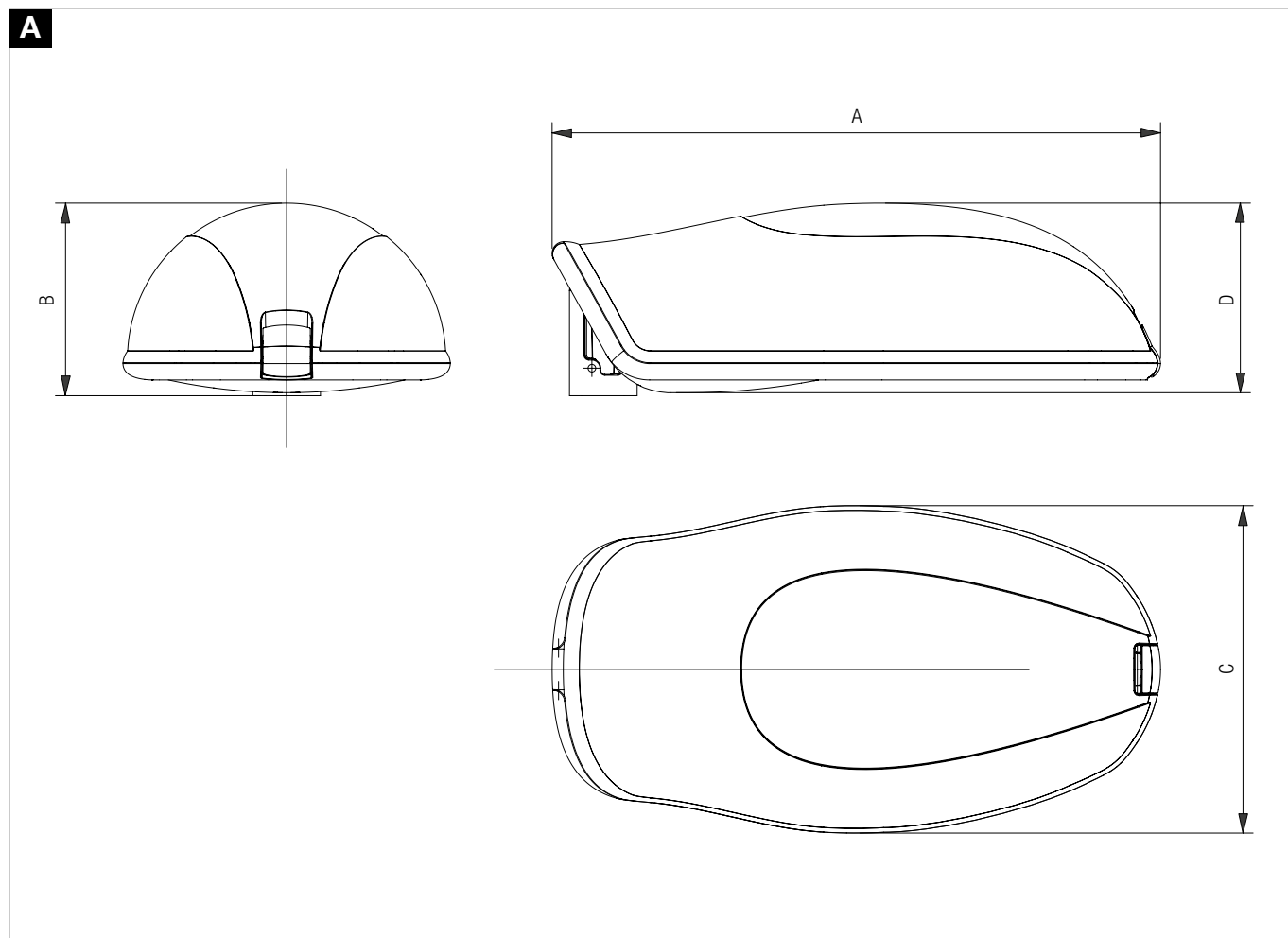

## M400 Polar diagrams - photometric data

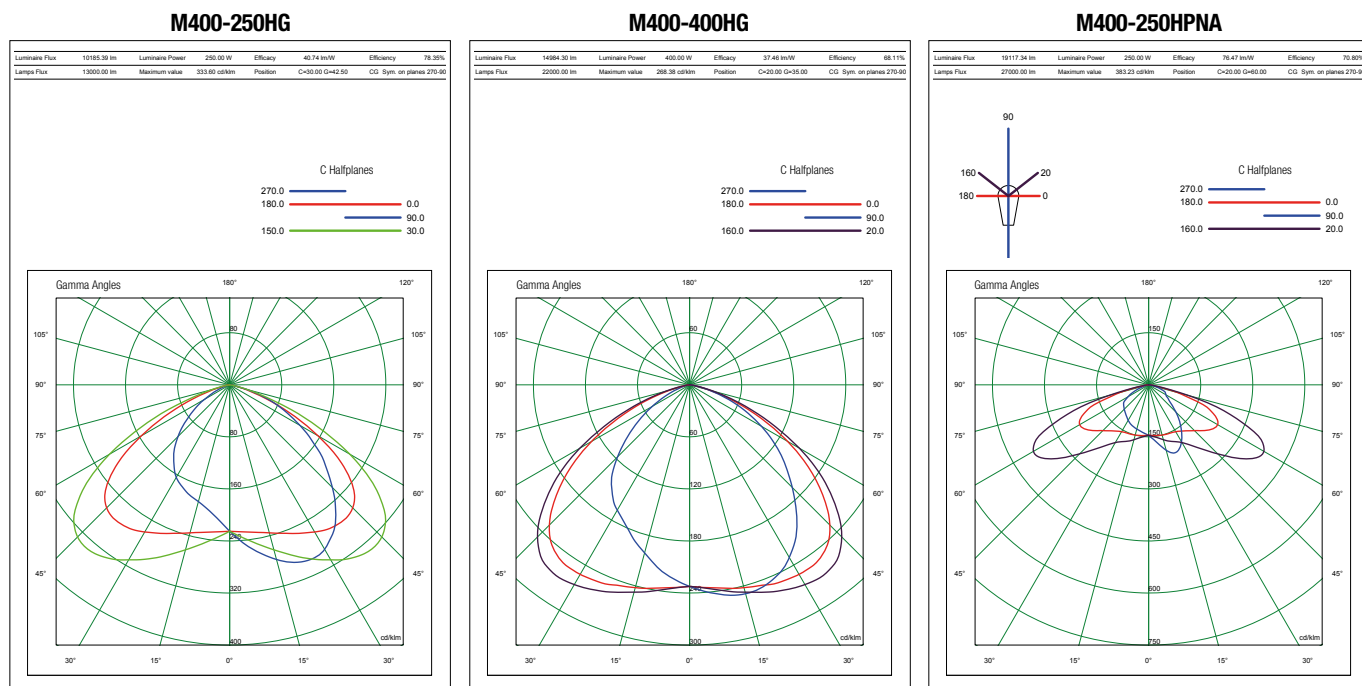

**M400-400HPNA**

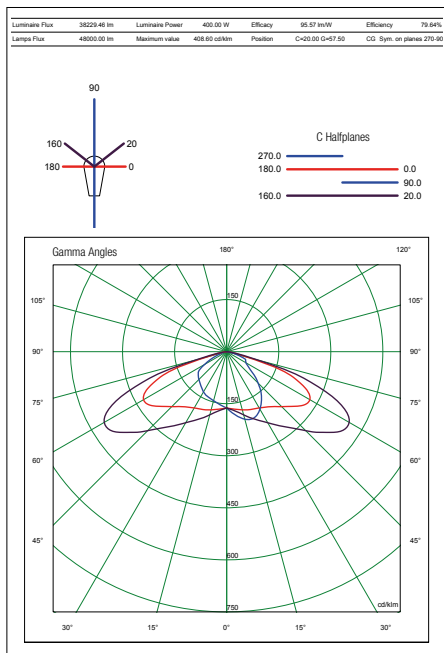

**M400-250MH**

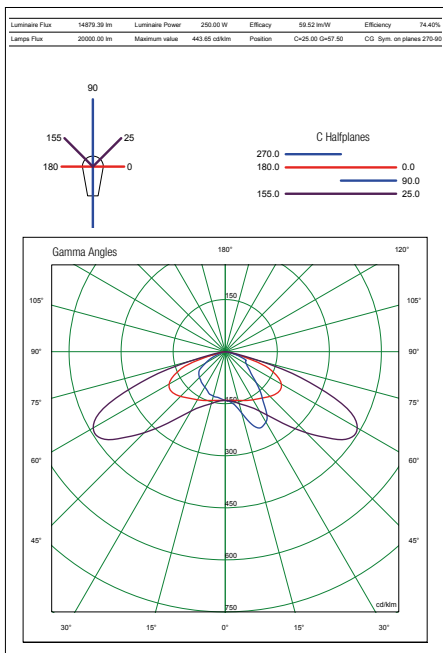

**M400-400MH**

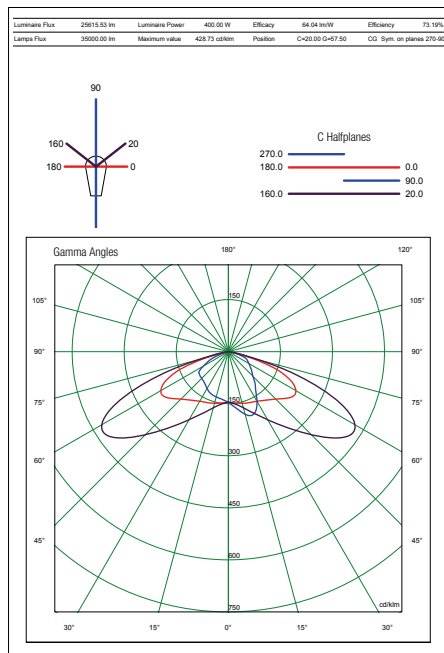

**On request accessories**

CODE	DESCRIPTION	MATERIAL
20303.0120	ANGLE/WALL INSTALLATION BRACKET	PAINTED STEEL
20303.0121	POLE ADAPTER - DIA. 40÷60MM	ALUMINIUM
20303.0125	POLE ADAPTER - DIA. 76 MM	PAINTED STEEL

**Angle/wall installation bracket**

**20303.0120**



**Pole adapter - dia. 40 mm**

**20303.0121**



**Pole adapter - dia. 76 mm**

**20303.0125**



**REMARK:**

Due to the development of the national and international specifications and of the technology, the above technical characteristics showed on this bulletin can be considered as binding on our confirmation only.

